

iMPAKT

**2 Inch DS SEG Fabric Frame
Assembly and Installation
Instructions**

01 Component List

	DESCRIPTION
A	Extrusion- 2 inch SEG Fabric Frame
B	Corner Connectors
C	Corner Reinforcement
D	Foot- Side mount
E	Hex bolt and nut
F	Straight connector x 2

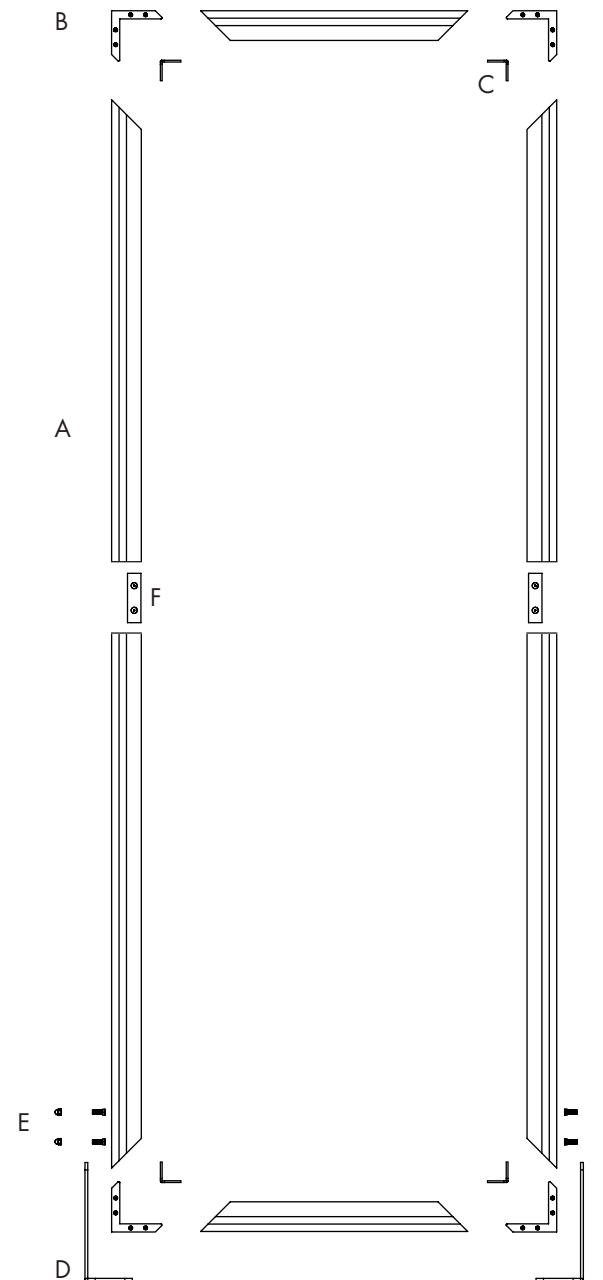
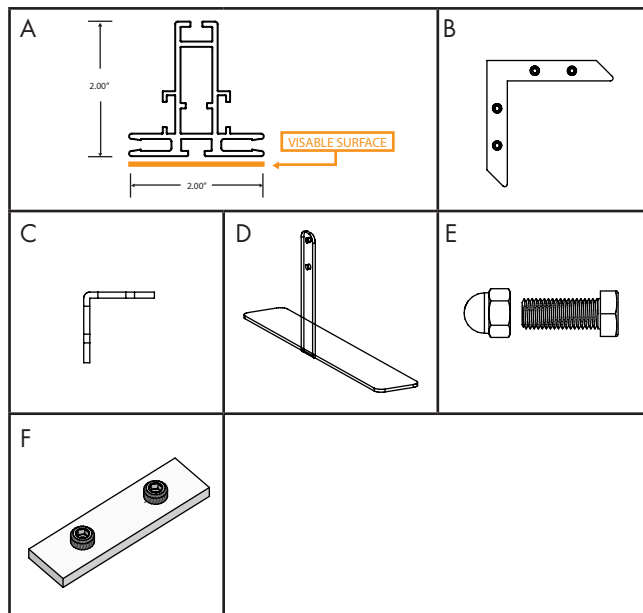

02 Assembly

Insert 2 hex bolts (E) into outside channel of each of the vertical frame extrusions (A)

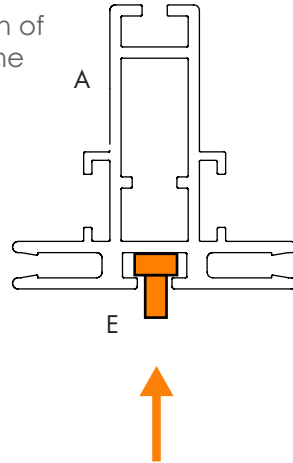

A

E

Insert 2 corner connectors (b) and 1 corner reinforcement (c) into inside channels as shown

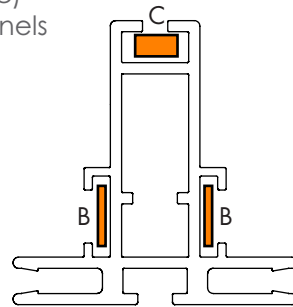

Align corners and tighten

Tighten the set screws in the corner connectors (b)

The hex bolts (e) are still loose at this point



03 Assembly

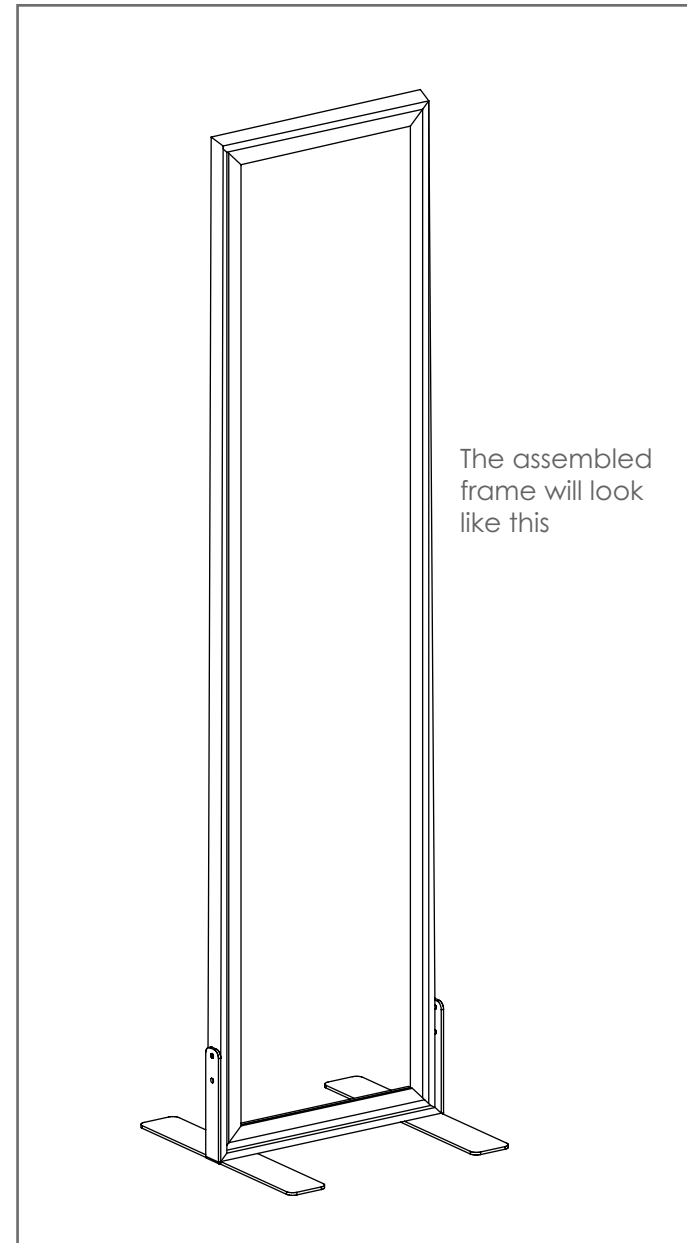
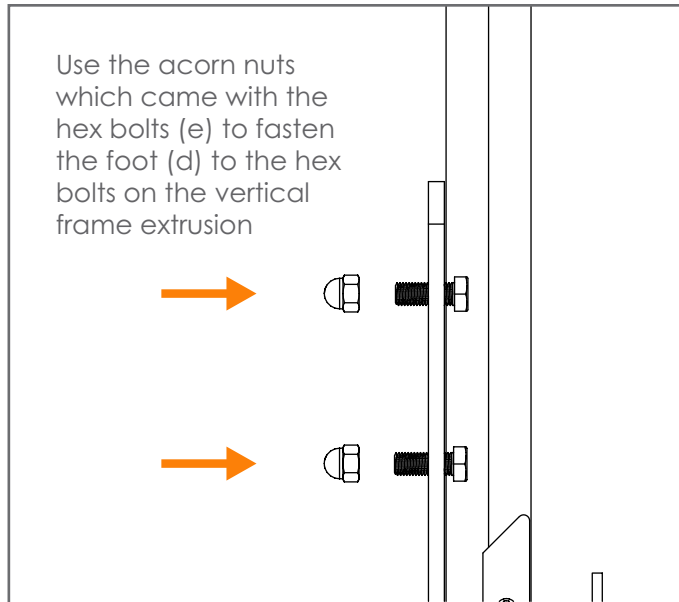

INSTALL SEG FABRIC

iMPAKT

1 From front side of frame, insert fabric graphic into all 4 corners first, in diagonal order.

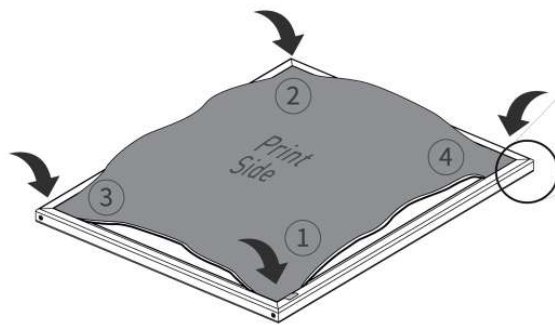

TIP Be sure printed side is facing out and the silicon edge is oriented as shown here.

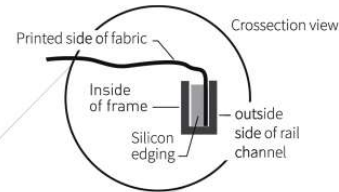

2 Insert fabric edge only at the center of each channel, pushing directly downward.

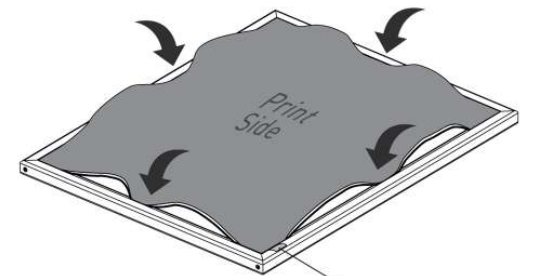

Pull-tab for removing fabric graphic, is sewn into edge and can also be tucked away.

3 Use downward pressure to insert the remaining edge, working out from the center toward each end.

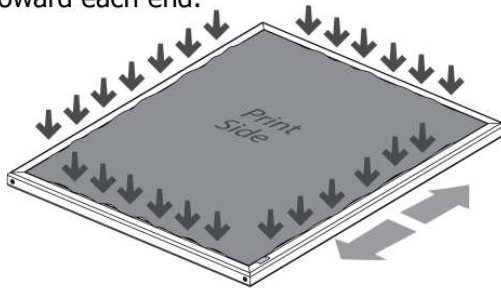

4 Complete.

